

GCI Rotary Roll Handler

The Manual Alternative for 90° Power Tilt Applications

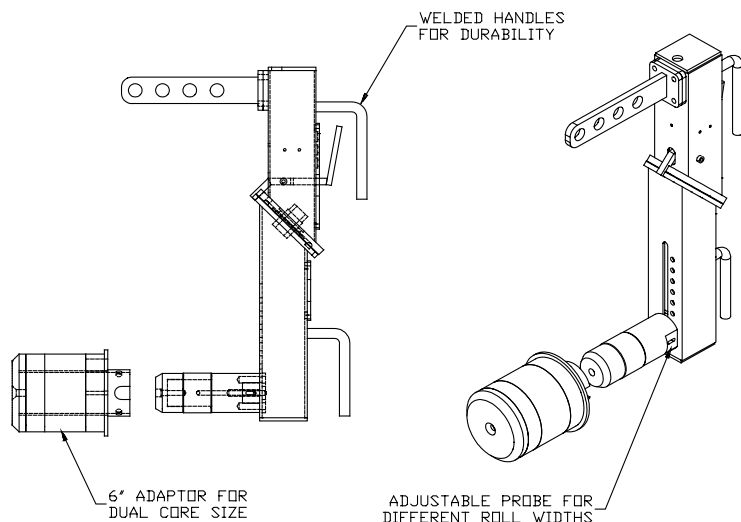

Specifications

Capacity: 200 Lbs
Air Supply: 80 psi
Approx Shipping wt: 55 Lbs
Core Size: 3" &/or 6"
Max Roll Width: 24"
Adjustable Probe for Proper Rotation
Multiple Hook Locations

IT'S EASY TO USE:

The GCI Rotary Roll Handler provides an excellent means for pick and place as well as 90° tilting for rolls of any kind with either 3" or 6" cores. The expanding rubber probe will work with any core type including paper, PVC and steel.

IT'S FAST:

Quick change ends are available to accommodate those with both 3" and 6" cores. To change to the 6" probe simply slide it over the 3" probe and lock in place, the roll handler is now ready to handle a 6" core.

IT'S SAFE:

The regulator controlling the expanding probe is preset and locked in position at the factory, then mounted inside an access panel on the roll handler to prevent tampering. A pressure gage on the outside serves as an on/off indicator as a check to make sure proper air pressure is supplied to the probe.

Safety is maintained with the GCI Rotary Handler by using a One button On, Two button Off configuration.

Custom applications also available.

Manufactured by:

GCI, 505 County Road 40 NW, Garfield, Minnesota 56332
Tel 320-834-2211, Fax 320-834-2212, Toll Free 800-758-5126
Web Site - www.gcilift.com, Email - sales@gcilift.com

